

Technical Data Sheet V 89x5

Basic Info

KSF V	KSF V	KSF V	KSF V	KSF V	KSF V	KSF V
89x5,0x	89x5,0x	89x5,0x	89x5,0x	89x5,0x	89x5,0x	89x5,0x
2000 PT HDG	1500 PT HDG	1500 EH HDG	1500 ET HDG	1500 E HDG	860 E HDG	300 M24 HDG
Nominal length (mm)						
2000	1500	1500	1500	1500	860	300
Tube diameter (mm)						
89	89	89	89	89	89	89
Weight (kg)						
23	18	20	16	15	9	6
Steel grade (tube)						
S 235	S 235	S 235	S 235	S 235	S 235	S 235
Item number						
A0513	A0512	A0510	A0511	A0509	A0516	A0504



KSF V
89x5,0x300 M24
HDG



KSF V
89x5,0x2000 PT
HDG

Construction

- Flange: Sheet metal S 355
- Continuous welded helix
- Hot-dip galvanizing according to DIN EN ISO 1461
- Extra hard Hardox drive point
- Extra thick 5-mm-helix

Accessories



Screw Set KSF V 89 M24
Art.-Nr. A1380



KSF V
89x5,0x1500
ET HDG



KSF V
89x5,0x1500
EH HDG



KSF V
89x5,0x860 E
HDG



sustainable · durable · revolutionary

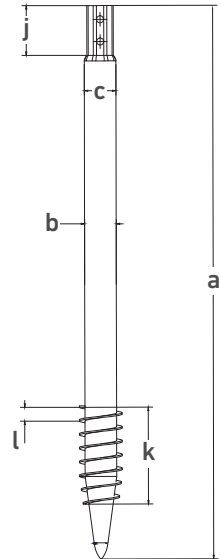
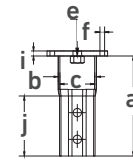
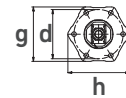

Technical Data

	KSFV 89x5,0x 2000 PT HDG	KSFV 89x5,0x 1500 PT HDG	KSFV 89x5,0x 1500 EH HDG	KSFV 89x5,0x 1500 ET HDG	KSFV 89x5,0x 1500 E HDG	KSFV 89x5,0x 860 E HDG	KSFV 89x5,0x 300 M24 HDG
a	Length (mm)						
	2000	1500	1500	1500	1500	860	300
b	Outer diameter (mm)						
	89	89	89	89	89	89	89
c	Inner diameter (mm)						
	79	79	79	79	79	79	79
d	Pitch circle diameter (mm)						
	-	-	-	-	-	-	150
e	Central thread						
	-	-	-	-	-	-	M24
f	Pitch circle holes (mm)						
	-	-	-	-	-	-	6 x Ø 14
g	Flange wrench size (mm)						
	-	-	-	-	-	-	166
h	Flange outer diameter (mm)						
	-	-	-	-	-	-	182
i	Flange thickness (mm)						
	-	-	-	-	-	-	15
j	Octagon connection height (mm)						
	180	180	180	180	180	180	180
k	Thread length (mm)						
	450	450	-	250	-	-	-
l	Thread pitch (mm)						
	50	50	50	50	-	-	-

